

MODEL ESTIMATE

UNDER

13th Finance Commission for the year 2012-13.

NAME OF WORK:

**CONSTRUCTION OF MARKET SHED AT DIFFERENT PLACES OF DHEMAJI
DISTRICT.**

NAME OF ZILLA PARISHAD:

DHEMAJI ZILLA PARISHAD, DHEMAJI.

ESTIMATE AMOUNT:

Rs. 25,00,000.00

(RUPEES TWENTY FIVE LAKHS) ONLY.

Name of Work : Construction of market shed at different places of Dhemaji District under 13th Finance Commission for the year 2012-13.

Name of Zilla Parishad : Dhemaji Zilla Parishad, Dhemaji.

Name of G.P. :

Name of District : Dhemaji

Estimated Amount : Rs. 25,00,000.00

REPORT

This estimate amounting to Rs. 25,00,000.00 (Rupees Twenty Five lakhs) only has been framed to show the probable cost of Construction of market shed At different places of Dhemaji District under 13th Finance Commission for the year 2012-13.

This scheme is proposed to be constructed to facilitated the public. The following provisions have been made in this estimate:

1. Brick Work in Sub & Super structure
2. Earth Filling in Plinth
3. Plastering with Flooring
4. Colour Washing etc.

This estimate is prepared as per APWD, SOR (Building) for the year 2010-11.

All work will be carried out as per current general specification of the mentioned schedule.

Countersigned by

Estimate prepared by

Assistant Engineer
Dhemaji Zilla Parishad
Dhemaji

ABSTRACT OF COST

A. CIVIL COST

(I) Ground Floor Rs. 27,30,830.92

B. SERVICES

(I) Internal Electrification % Rs.

(II) External Electrification % Rs.

(III) Normal Preparation of Sites Rs.

Total Rs. 27,30,830.92

Less for Contractor's Profit 10%

C. INTERIOR DECORATION i. e. Furniture Rs. 2,73,083.09

Total Rs. 24,57,747.38

Add % Contingency Rs. }

Add % Labour Cost Rs. } 49,154.94

Grand Total Rs. 25,06,902.32

Say Rs. 25,00,000/-

(Rupees *Twenty Five Lakh* only) only

Note : This estimate has been prepared on the basis of A.P.W.D. schedule of rates Building for the year 2010-11.

Assistant Engineer
Dhemaji Zilla Parishad
Dhemaji

Asst. Project Officer (Tech)
BRDA/DZP Dhemaji

Item of Work *const. of Harkol shed at different places of Sheemaji District under 16th Finance Commission for 2012-13.*

Sl. No.	Item of Work	Unit	Rate	Quantity	Amount in Rs.
	Earth Work				
1.	Earth Work in excavation for foundation trenches of walls, retaining walls, footing of columns, steps, Septic Tank etc. including refilling (return filling) the quantity as necessary after completion of work, breaking clods in return filling, dressing, watering and ramming etc. and removal of surplus earth with all lead and lifts as directed and specified in following classifications of soils including bailing out water where necessary as directed and specified. Up to a depth of 2m below the existing ground level a) In ordinary soil	M ³	64.67	243.46	15,744.55
2.	Earth/sand filling in plinth in layers not more than 150mm thick including necessary carriage, watering, ramming etc. Complete as directed and specified including payment of land compensation, forest royalty, Sales Tax and other duties & taxes as may be necessary. a) With hill, river sand obtained by truck including loading and unloading and carriage to the site of work.	M ³	291.56	128.00	37,319.68
	Plain Cement concrete Work				
3.	Plain Cement concrete works with coarse agg. Of sizes 13mm in foundation bed for footing, steps, walls, brick work etc. as directed and specified, including curing complete. (Shuttering shall be measured and paid separately) a) In Prop. 1 cement:3 sand : 6 coarse agg. By volume	M ³	3733.63	66.744	2,49,197.00
	Cement Concrete Work				
4	Providing and laying cement Concrete for R.C.C. work in Prop. (1:1 1/2 :3) (1 cement : 2 coarse sand : 3 graded				

C.O. B 302,281.63

[Signature]
Assistant Engineer
Sheemaji Zilla Parishad
Dhemaji

B.F.B 302261'69

	stone chips-20mm down) including curing complete but excluding cost of form work and reinforcement for R.C.C. (from work and reinforcement shall be measured and paid separately). In sub. Structure up to P.L. a) Footing, Column below plinth and plinth Beam	M ³	5164.83	133.50	6,89,504.80
5.	Providing and laying cement Concrete for RCC work in prop. 1:2:4 (1 cement : 2 coarse sand : 4 graded stone chips-20 mm down) including curing complete but excluding cost of form work and reinforcement for R.C.C. (from work and reinforcement shall be measured and paid separately) In super structure From P.L. to F.F. level b) Column Beam Slab, Lintel	M ³	5364.16		
	Shuttering				
6	Providing from work of ordinary timber planking so as to give a rough finish including centering, shuttering strutting and propping etc. height of propping and centering below supporting floor to ceiling and removal of the same for in situ reinforced concrete and plain concrete work. In sub structure up to plinth level a) Foundation base, column, tie beam etc.	M ²	191.27		
7	Providing form work of ordinary timber planking so as to give a rough finish including centering, shuttering strutting and propping etc. height of propping and centering below supporting floor to ceiling and removal of the same for in situ reinforced concrete and plain concrete work. a) Column, Beam, Slab etc.	M ²	243.80	1100.58	2,68,321.40
	Door, Window & Ventilators				
8	Providing wood work in frame (chowkath) of door, windows, clerestory windows and masonry walls including supplying, fitting and fixing with M.S. flat hold fast (40mm				

12.60.057.83

Assistant Engineer
Dhemaji Zilla Parishad

B.F. Rs 12,60,087.88

	x 3mm x 25mm) as per design and embedded in cement concrete block in prop. 1:1:4 and with two coats of kiricide oiling to the timber faces in contact with C.C. and masonry as directed and specified. a) Sal wood	M ³	43969.25		
9	Providing, fitting and fixing fully glazed window with sash bars including oxidized M.S. but hinges (75 x 60 x 3.15) 2 nos. on each leaf and 3 nos on single leaf (glass panel to be measured and paid separately) b) With 1 st class local wood (Gamari/Bonsum/Hollock) i) 40mm thick, single shutter	M ²	1779.33		
10.	Providing and fixing flush door shutters solid core const. with frame of 1 st class hard work with cross band and face panels conforming to relevant I.S. iron but hinges (10 x 75 x 3.5)mm 6 nos with necessary wood screws. a) Decorated type face panel and block board core of 35mm thick	M ²	2791.96		
11.	Providing and fixing clear sheet glass badded in putty including necessary cutting of glass to required sizes (4mm thick)	M ²	496.99		
12.	Providing soling in foundation and under floor at all levels with stone/best quality packed jhama bricks, sand packed and laid to level and in panel after preparing the sub grade as directed. a) Brick flat soling	M ²	286.38	349.20	1,00,603.89
13.	Brick work in cement mortar with 1 st class brick including racking out joints and curing complete as directed in substructure up to plinth level. a) In prop. 1:5	M ³	4423.20	20.70	91,560.24
14.	112mm thick 1 st class brick nogged wall in cement mortar embedded with protruding rod in column including racking out joint and curing complete as directed in super structure above plinth up to 1 st floor level (protruding M.S. rod/Tore steel will be measured				

14,51,651.96

Assistant Engineer
Dhemaji Zilla Parishad
Dhemaji

B.F.B 14,51,651'96

	and paid for separately under relevant item of steel work) a) In cement mortar in prop.	M ²	518.62	326'40	1,69,277'58
	Plastering				
15	15mm thick cement palster in single coat on fair side of brick/concrete wall and ceiling for interior plastering up to 1 st floor level including arrises and /or rounded angles not exceeding 80mm in girth and finished even and smooth including curing complete as directed. (In cement mortar 1:4) a) Wall	M ²	111.25	893'20	93,806'00
16	15mm thick cement plaster in two coats backing coat 10mm finishing coat 5mm thick on rough side of single or half brick wall for interior plastering up to 1 st floor level including risers, internal rounded angles not exceeding 80mm in girth and finished even and smooth including curing complete as directed. a) In cement mortar 1:4	M ²	138.57		
17	10mm thick cement plaster on ceiling and soft of stair case up to 1 st floor level including curing complete as directed.	M ²	464.68		
	Painting				
18	Applying priming coat over new wood based surface over 10 cm in girth/width after and including cleaning oil, grease, dirt and foreign matter sand papering and knotting. a) With ready mixed paint, brushing white lead for primary.	M ²	29.70		
19	Painting two coat (excluding primary coat) on new wood based surfaces with enamel paint to give an even shade including cleaning the surfaces of dirt, dust and other foreign materials, sand papering and stopping. (Surfaces over 10 cm width/girth) (i) With Apcolite	M ²	54.82	113'12	6201'23
20	Distemper with dry distemper of approved brand and manufacture (2 coats) and of required shade on new wall surface to give on even shade				

17,20,936'15

 Assistant Engineer
 Dhemaji Zilla Parishad
 Dhemaji

B.F. A 1720936.15

	over and including priming coat of white primer after thoroughly brushing the surface free from mortar droppings and other foreign matters including prepared the surface even and papered smooth.	M ²	62.42	843'20	52,632.54
21	Extra over item 13.3.2b of above for distempering with dry distempering on ceiling and of the sloping roofs.	M ²	62.42		
	Flooring				
22	40mm Thick P.C.C. flooring base of 25mm down agg. With neat cement slurry.	M ²	449.48	160'60	71,916.80
23	Marble stone slab flooring including treads of steps exceeding 30cm with laid over 20mm thick base of cement plaster 1:6 laid jointed with white cement slurry including rubbing and polishing complete with marble slab of specified quality. 20mm thick marble slab	M ²	1510.46		
24	6mm thick glazed tiles wall & floor over cement slurry as per specification.	M ²	606.08		
	Steel Re-Inforcement				
25	Supplying fitting and fixing in position reinforcement bars conforming to relevant IS Code for RCC work/R.B. Wailing including straightening, Cleaning, cutting and bending to proper shapes and length as per details, supplying and binding with 20 G annealed black wire and placing in position with proper blocks, supports, chairs etc., complete a) High Yield Strength Deformed Bars/Tor steel	QTL	4746.00	156'00	7,40,376.00
26	Providing fitting and fixing M.S. grill of required pattern for openings with M.S. flats at required spacing in frame all round square or round M.S. bars with round headed bolts and nuts or screws.	Kg	63.27		
27	Providing fitting and fixing rolling shutters of good quality iron sheet including spring-revolving axil, both side channel etc.	M ²	2563.10	56.58	144,968.92
					Total Rs 27,30,830.92

 Assistant Engineer
 Dharmaji Zilla Parishad,
 Dharmaji

**CALCULATION FOR GROUND FLOOR ESTIMATE OF R.C.C. BUILDING
FOR MARKET SHED**

Area =

Wall Length = 78.00 M W4 = , W3 = , W2 = , W1 =

Col = 30 x 30 CM Beam = 45 x 45 CM Door = 2.60 x 2.00 M

Sl. No.	Item of Work	Calculation	Quantity	Rates	Final Qunatly
1.	Earth work in ecavation		243.46	64.67	
2.	Plinth filling (River Sand)	2000 x 8.00 x 0.80	128.00	322.75	
3.	Brick Soling (Flat Brick) Below Footing Tie beam & Floor		Total 399.20	286.37	
4.	P.C.C. below footing		64.74	3733.63	
5.	R.C.C. below PL Footing Footing Column Beam		Total 133.50	4734.15	
6.	R.C.C. above PL to FF Column Beam Slab Lintel Chajja		Total	4929.24	
7.	Shutt below PL Footing Tie Beam Coloumn Chajja		Total	191.27	
8.	Shutt above PL to FF Floor slab Floor beam Coloumn		Total 1100.58	243.80	
9.	230 tk Bk. Work in Plinth		20.70	4632.29	
10.	Wood work in door/win.			43969.25	
11.	Flush door			2947.16	
12.	Window/Ventil.			1779.33	
13.	112 tk Bk. Work in wall Room Wall		826.40	518.62	



 Assistant Engineer
 Dhemaji Zilla Parishad
 Dhemaji

14.	Out side plaster in wall		843.20	111.25	
15.	In side plaster in wall Beam side			138.57	
16.	Ceiling Plaster			138.57	
17.	65mm thick floor base		160.00	449.48	
18.	15mm thick Marble floor			2232.30	
19.	6mm thick glazed tiles			606.08	
20.	Wood paint 1 st			29.70	
21.	Wood paint 2 nd			54.82	
22.	Distemp. In wall		843.20	62.42	
23.	Distemp. Ceiling			62.42	
24.	Glass			496.99	
25.	Rolling shutters		56.56	2563.10	
26.	M.S. Grill in win/ven. M.S. Railing in Ver/balc			63.27	
27.	Reinforcement Up to Plinth level Footing 12 Tor Coloumn 20 tor Coloumn 16 Tor. Colouring 8 Tor Tie Beam 16 Tor Tie's ring 8 Tor From PL to FF level Coloumn 20 Tor. Coloumn 16 Tor. Coluring 8 Tor Floor beam 20 Tor. Floor Beam 16 Tor Ring 8 Tor. Slab 10 Tor. Slab 8 Tor			47.46	
			Total		

156.00 Borda

Asstt. Project Officer (Tech)
DRA/DSP Dharmaji

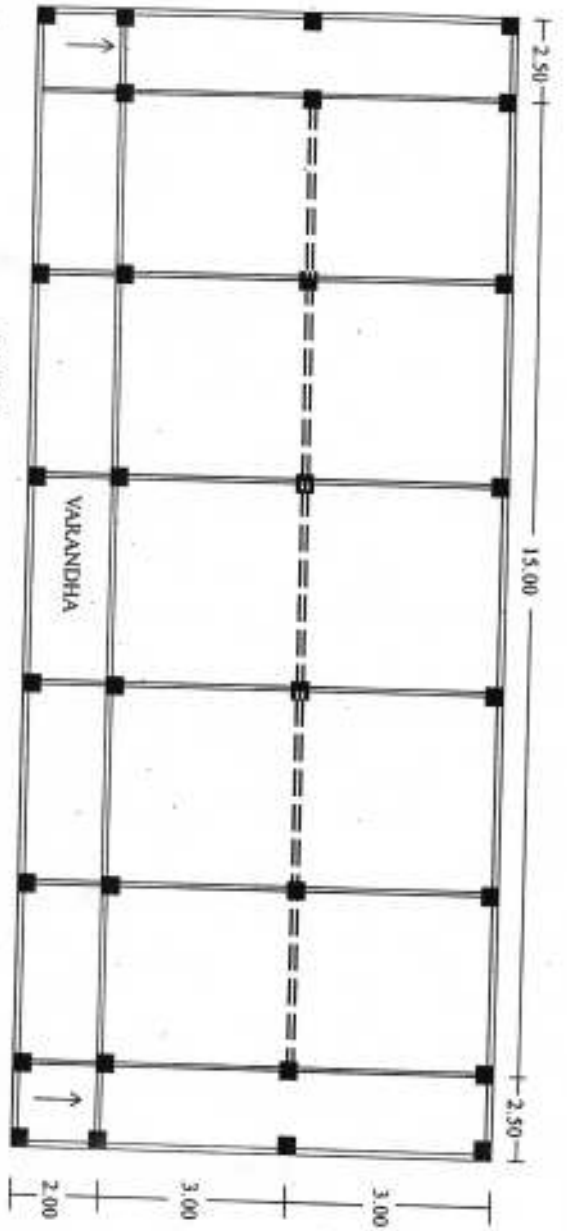

Assistant Engineer
Dharmaji Zilla Parishad
Dharmaji

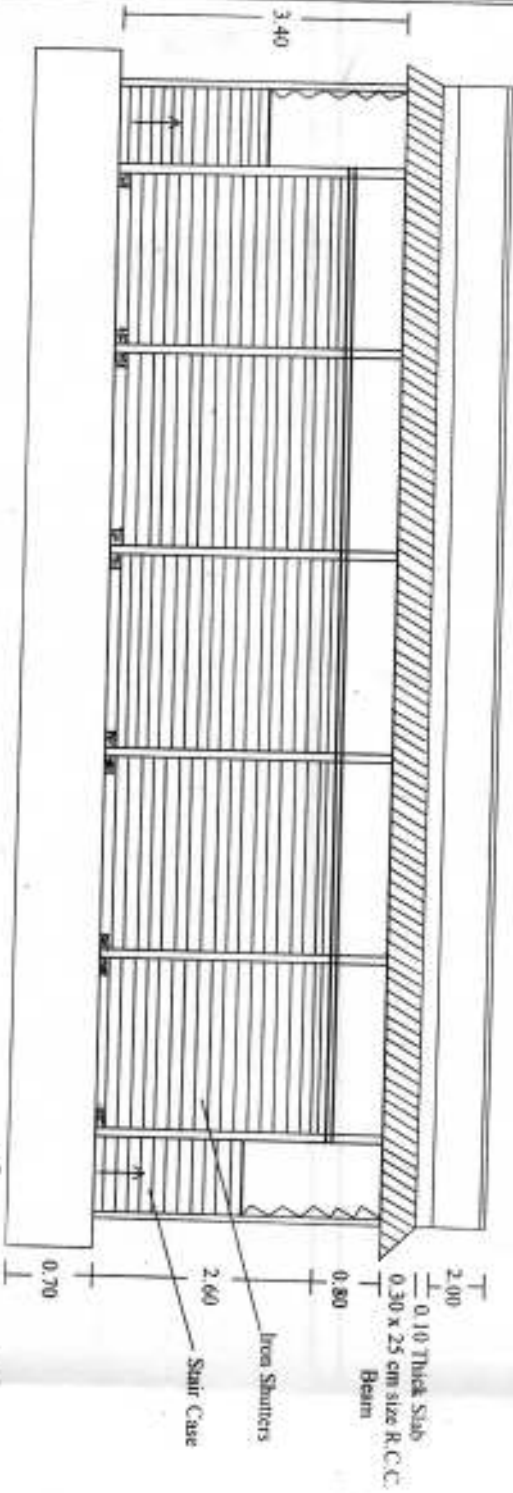

PLAN

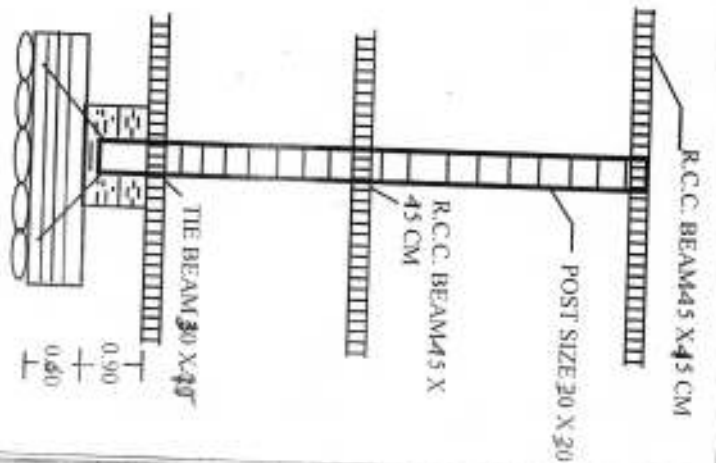

Assistant Engineer
Dharmaji Zilla Parishad
Dharamshi



MAIN POSTS 'A' =
VARANDHA POSTS =

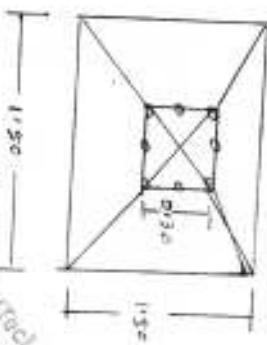

Project Officer (Rec)
Dharmaji Zilla Parishad
Dharamshi

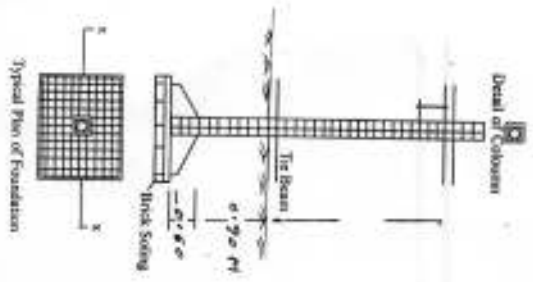
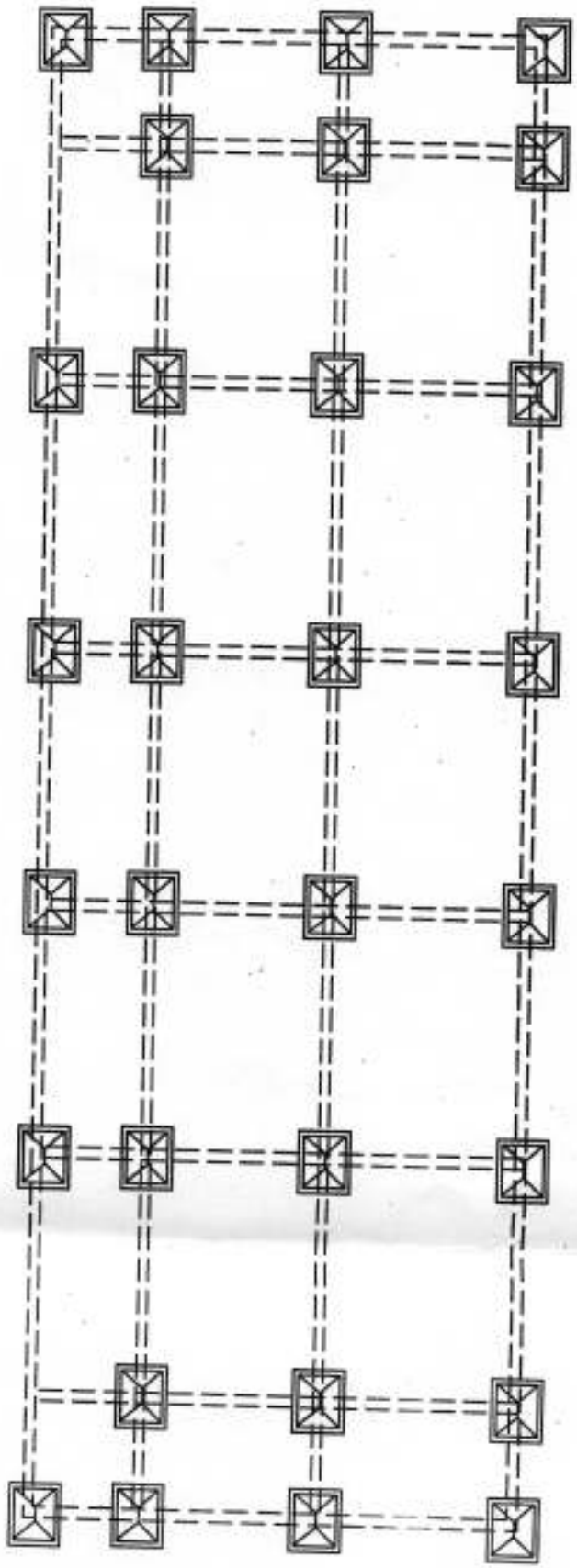

 Usmaraji Zilla Parishan
 Dhemaji

 Project Officer (Tech)
 Dhemaji