

GOVT. OF ASSAM
OFFICE OF THE TINSUKIA ZILLA PARISHAD
TINSUKIA

No : TZP/612/2011-12/ 3383

Dt. 10/01/2013

To,

The Director,
Finance(E & A) Deptt.,
Disput, Guwahati.

Sub: Submission of plan & estimate of new market sheds to be constructed under the award of 13th Finance Commission.

Ref: WT No. FEA(SFC)133/2012/142, dtd. 07.01.2013.

Sir,

With reference to the above, I am to submit herewith the plan & estimate of the following market sheds to be constructed under the award of 13th Finance Commission in both hard & soft copy.

- | | | | |
|----|------------------------------------|---|---------------|
| 1) | Baghjan Bazar | - | Hapjan AP |
| 2) | Pengeri Bazar | - | Margherita AP |
| 3) | Chapakhowa Bazar | - | Sadiya AP |
| 4) | Philobari Ghurni Mangalboria Bazar | - | Kakopathar AP |

This is further to inform you that Shri Satindra Nath Barman, JE of this office has been deputed to attend your office along with the plan & estimate as per direction contained in the WT.

This is for favor of your kind information and necessary action etc.

Yours sincerely,



(A. ARANDHARA, ACS)
Chief Executive Officer
Tinsukia Zilla Parishad
Tinsukia

Memo No : TZP/612/2011-12/
Copy to:

Dt. 10/01/2013

1. Shri Satindra Nath Barman, JE, Tinsukia Zilla Parishad for information and necessary action.



Chief Executive Officer
Tinsukia Zilla Parishad
Tinsukia

GOVT. OF ASSAM
OFFICE OF THE TINSUKIA ZILLA PARISHAD
TINSUKIA

Name of the work : Model estimate for Development of Bazar under Tinsukia Zilla Parishad.

Name of Block : Margherita/ Sadiya/ Hapjan/ Kakapother .

Name of GP :

Estimated Amount : Rs. 25,00,000.00

This model estimate amounting to Rs. 25,00,000.00 (Rupees Twenty Five Lakh) only have been prepared to show the probable cost for Development of Bazar under Tinsukia Zilla Parishad.

REPORT

This model estimate amounting to Rs. 25,00,000.00 (Rupees Twenty Five Lakh) only have been prepared to show the probable cost for Development of Bazar under Tinsukia Zilla Parishad.

This estimate has been prepared as per schedule of rate of APWD Building for the year 2010-11 & APWD Roads for the year 2009-10.

Jr. Engineer
Zilla Parishad, Tinsukia

Chief Executive Officer
Zilla Parishad, Tinsukia

Name of Work : Model estimate for development of bazar under Tinsukia Zilla Parishad.

Name of Block : Margherita/ Sadiya/ Hapjan / Kakapothor.

Estimated Amount : Rs. 2500000.00

(A) Construction of open market shed

- Item No. 1/1.1 Earth work in excavation for foundation trenches of walls, post, septic tank etc. including refilling the qty. as necessary after completion of work, breaking clods in return filling, dressing, watering and ramming etc.
- Post
 $28 \times 0.8 \times 0.8 = 17.92 \text{ m}^3$
 $4 \times 10 \times 0.4 \times 0.4 = 6.4$
 Total = 24.32
 @ Rs. 64.57/m³ Rs. 1573.00
- Item No. 2/4.1.1 Providing brick soiling in foundation and under floor with best quality brick, sand packed and laid to level and in panel after preparing the subgrade as directed including all labour & materials and if necessary dewatering, complete.
- Post
 $28 \times 0.8 \times 0.8 = 17.92$
 $10.0 \times 0.4 \times 0.4 = 16.0$
 $15.0 \times 6.0 = 90.0$
 Total = 123.92
 @ Rs. 424.01/ m² Rs. 52543.00
- Item No. 3/2.1.1 Providing & laying plain cement concrete work in prop. 1:2:4 including dewatering if necessary, and curing complete but excluding cost of form work & reinforcement for reinforced cement concrete work.
- $15.0 \times 4 \times 0.25 \times 0.10 = 1.5$
 $2 \times 6.0 \times 0.25 \times 0.10 = 3.0$
 Total = 1.8
 @ Rs. 3733.63/m³ Rs. 6720.00
- Item No. 4/2.1.1 Providing & laying plain reinforced cement concrete work in prop. 1:2:4 including dewatering if necessary, and curing complete but excluding cost of form work & reinforcement for reinforced cement concrete work.
- $28 \times 0.8 \times 0.8 \times 0.2 = 3.584$
 $28 \times 0.4 \times 0.4 \times 0.3 = 1.344$
 $28 \times 3.25 \times 0.13 \times 0.13 = 1.548$
 Long beam
 $4 \times 15.0 \times 0.25 \times 0.3 = 4.5$
 Short beam
 $2 \times 6.0 \times 0.25 \times 0.3 = 0.9$
 Plinth wall
 $2 \times 15 \times 0.25 \times 0.45 = 3.375$
 $2 \times 15 \times 0.25 \times 0.30 = 2.25$
 $2 \times 6 \times 0.25 \times 0.3 = 0.9$
 $2 \times 2.2 \times 0.25 \times 0.3 = 0.64$
 Total = 21.041
 @ Rs. 5154.63/m³ Rs. 108673.00

Item No. 5/18.1.1	Supplying, fitting & fixing in position reinforcement bars conforming to relevant IS code for RCC work/RB walling including straightening, cleaning, cutting & bending to proper shapes & length as per details, supplying & binding with 20G annealed black wire & placing in position etc.	
	12 mm dia Post $4 \times 28 \times 4.2 \times 0.89 = 418.656$ kg $28 \times 28 \times 0.5 \times 0.22 = 86.24$ Beam $4 \times 4 \times 15.0 \times 0.89 = 213.6$ $4 \times 100 \times 1.0 \times 0.22 = 88.0$ $2 \times 4 \times 6.0 \times 0.89 = 42.72$ $2 \times 60 \times 1.0 \times 0.22 = 26.4$ Total = 875.616 = 8.76 qtl @ Rs. 5290.41/qrtl	Rs. 46344.00
Item No. 5/9.3.1	Providing MS black tube in roof trusses including purlins conforming to relevant IS code as per approved design & drawings including providing MS cleats, base plates etc.	
	Tie $7 \times 6.0 = 42.0$ m Truss $2 \times 3.8 \times 7 = 53.2$ strut $7 \times 1.2 = 8.4$ $2 \times 7 \times 1.5 = 21.0$ $2 \times 2 \times 7 \times 1.0 = 28.0$ $2 \times 2 \times 7 \times 0.8 = 22.4$ $2 \times 2 \times 7 \times 0.5 = 14.0$ Purlin $17.0 \times 5 \times 2 = 170.0$ Total = 359.3.27 = 1174.04 kg = 11.74 qtl @ Rs. 5875.00/qrtl	Rs. 68972.00
Item No. 7/8.1.2	Providing CGI sheet roofing of TATA Shaktee/SAIL including fitting & fixing necessary galvd. J or L hooks, bolts & nuts 8 mm dia with bitumen washer 25 mm dia X 3 mm thick & 1.6 mm thick limpet washer complete excluding cost of roof truss, purlin etc.	
	$17.0 \times 2 \times 3.8 = 129.20$ m ² @ Rs. 425.09/m ²	Rs. 54922.00
Item No. 8/8.1.4	Providing galvd. Iron ridging of TATA Shaktee/SAIL including supplying & fixing necessary galvd. screws etc. complete as directed.	
	Length = 17 m @ Rs. 148.88/m	Rs. 2531.00
Item No. 9/6.2.3	cement plaster 15 mm thick on brick wall, post etc.	
	$28 \times 4 \times 0.13 \times 2.5 = 36.4$ $4 \times 15.0 \times 0.45 = 27.0$ $2 \times 6.0 \times 0.45 = 5.4$ Total = 68.8 @ Rs. 110.21/m ²	Rs. 7582.00
Item No. 10/	Color washing etc.	
	@ L/S	Rs. 6211.00

Item No. 11/5-4.4 65 mm thick cement concrete floor consisting of 50 mm under layer of cement concrete in prop. 1:3:6 & 15 mm thick wearing layer in cement concrete in prop. 1:1:2 laid in panels & finished with a floating coat of neat cement finish etc.

15.0x6.0=90.0 m²
@ Rs. 449.48/m² Rs. 40453.00

Item No. 12/1.3 Earth/Sand filling in plinth in layers not more than 150 mm thick including necessary carriage, watering, ramming etc. complete as directed.

15.0x6.0x0.45=40.5 m³
@ Rs. 322.75/m³ Rs. 13476.00

Total Rs. 410000.00
Cost of one open shed Rs. 410000.00
Total (A) For 5 units Rs. 2050000.00

(B) CEMENT CONCRETE ROAD

Item No. 1/1.1 Earth work in excavation for foundation trenches of walls, post, septic tank etc. including refilling the qty. as necessary after completion of work, breaking clods in return filling, dressing, watering and ramming etc..

140.0x2.0x0.25=70.0 m³
@ Rs. 64.67/m³ Rs. 4527.00

Item No. 2/4.1.1 Stone masonry work in cement mortar 1:3 for sub-structure (soiling) as per tech. specification etc.

140.0x2.0x0.25=70.0 m³
@ Rs. 3715.00/m³ Rs. 260050.00

Item No. 3/ Supply, fitting & fixing of shuttering etc. Rs. 5293.00

Total (B) Rs. 269870.00
For 1 unit Rs. 269870.00
For 2 units Rs. 539740.00

(C) EARTH FILLING

Item No. 1/1.3 Earth/Sand filling in plinth in layers not more than 150 mm thick including necessary carriage, watering, ramming etc. complete as directed.

25.0x40.0x0.414=513.86 m³
@ Rs. 322.75/m³ Rs. 133572.00

Total (A+B+C) Rs. 2723312.00
Add 2% contingency Rs. 54466.00
Total Rs. 2777778.00
Less 10% contractor's profit Rs. 277778.00
Total Rs. 2500000.00
Rupees Twenty Five Lakh Only

Junior Engineer
Tinsukia Zilla Parishad
Tinsukia

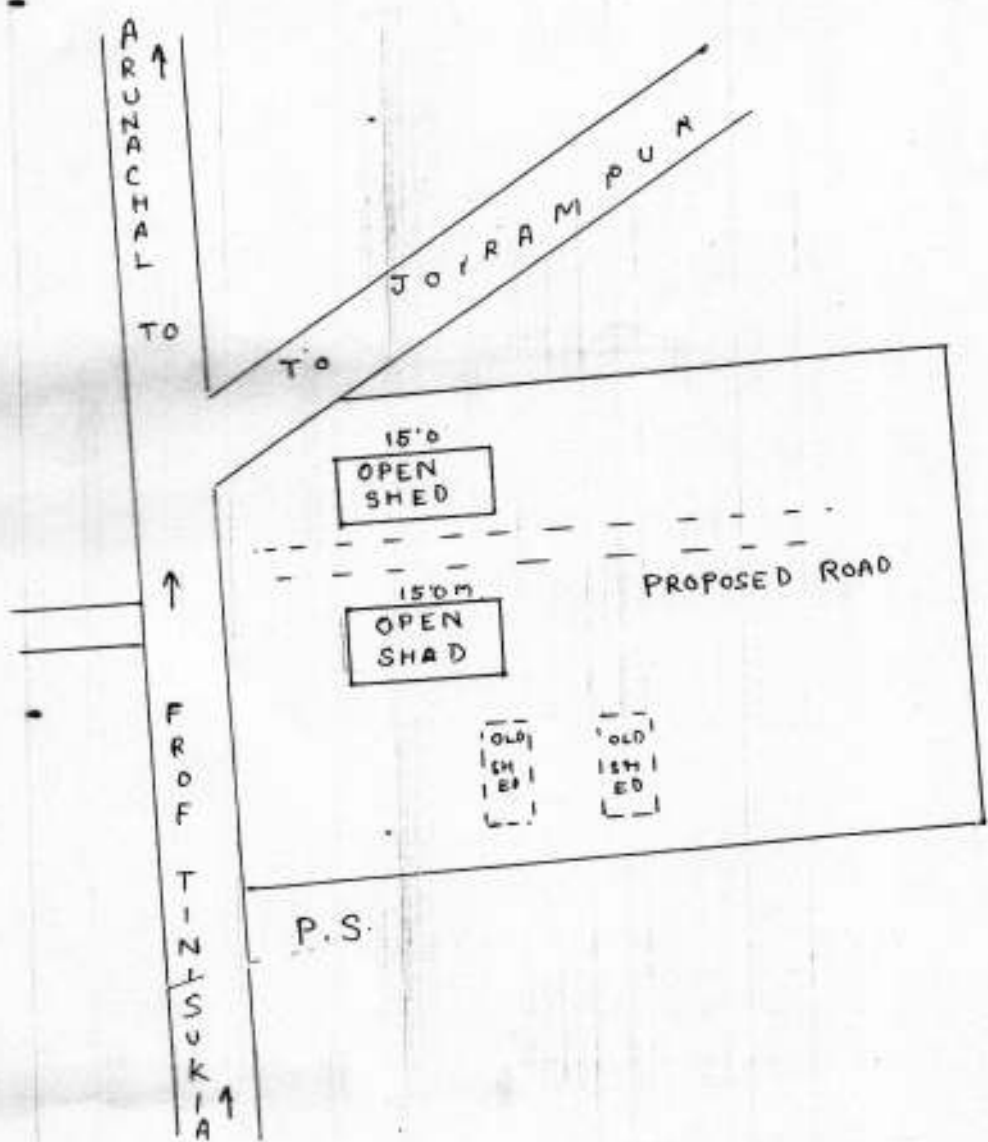

PLAN OF

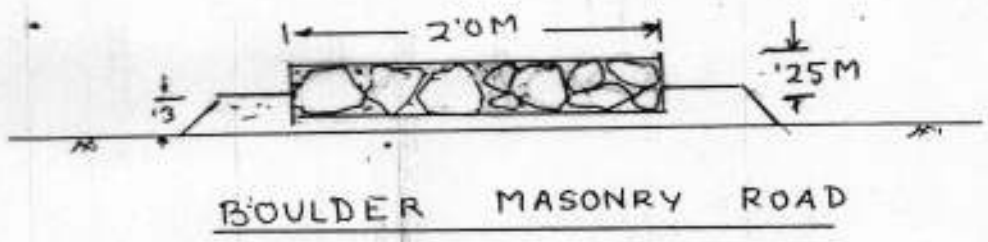

JCP

OPEN MARKET SHED

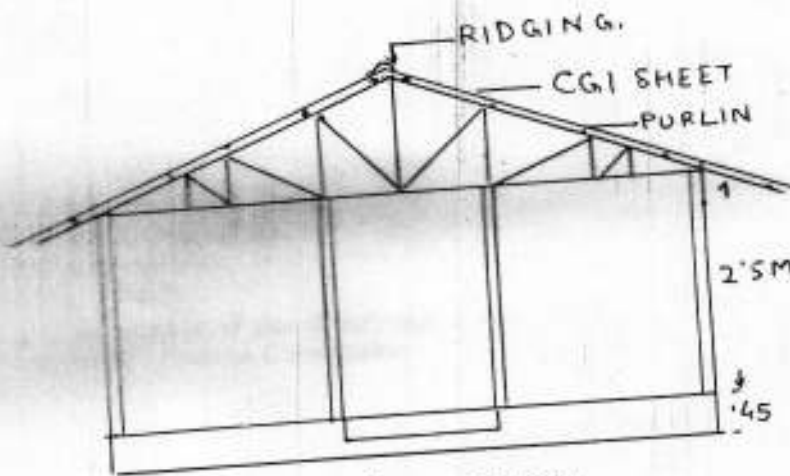

ELEVATION

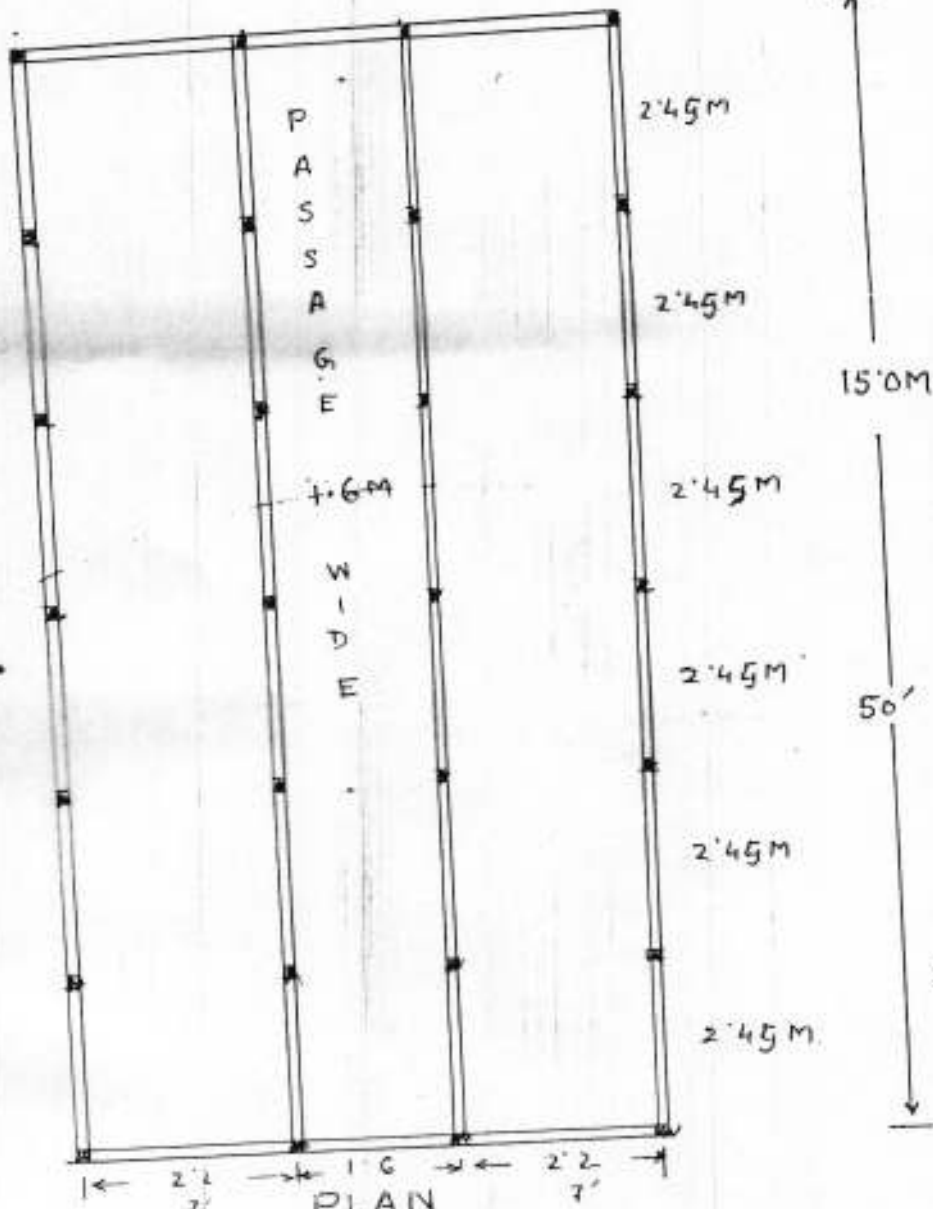
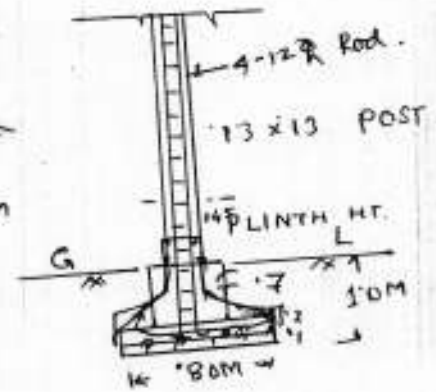

PLAN
SCALE 1:100

Signature
Junior Engineer
Tinsukia Zilla P.
Tinsukia